

# Connecting to Rayburn's Guest Wi-Fi

1. Select "REC – Guest" from your Wi-Fi settings.
2. A login page will open. Enter the following information and then click "Continue":
  - a. Your name;
  - b. Your email; and
  - c. The duration you need Wi-Fi.
3. Enter the email of a Rayburn employee to approve your access and click "Request Internet Access".
4. The employee will receive an email and approve your request.

#1

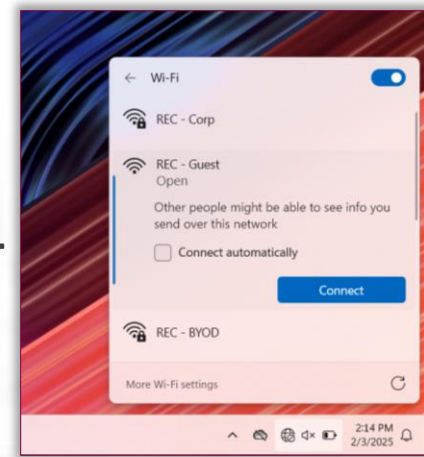

#2

#3